

Hoop-It-All™

Super~Giant-L™

The answer to your EXTRA BIG embroidery inspirations

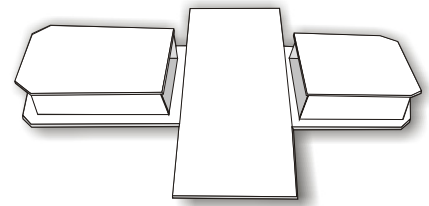

Baby-Lock Ellageo

Included:

- (1) Super-Giant Sliding Hoop-It-All™
- (1) 3 piece Support extension table
- (1) roll S-I-A™ Pressure Sensitive Adhesive Tear-Away
- (1) Special instructions

Another innovation from:



Patent # 5,555,828 - Patent # CP 2179119 - Other patents pending

Multiple designs with only (1) hooping

All claims made by Hoop-It-All, Inc. are achieved by using Hoop-It-All related products!

S-I-A™ Pressure Sensitive Adhesive tear-away stabilizer

The Giant Hoop-It-All™ kit includes, (1) roll of **S-I-A™ adhesive tear-away stabilizer**. This stabilizer is a necessary item for proper hoop function. It is attached to the back side of the Hoop-It-All™ with the sticky side facing up to hold the fabric in place during the embroidery. Fabric is not held in place with two rings as when using ordinary hoops.

Using the Hoop-It-All prevents stretching of the fabric, which can distort and possibly damage the fibers in some fabrics increasing puckering. No ring marks are left on velvet, suede, or corduroy. Embroidery can be done anywhere on the garment without interference caused by seams, pockets, facings, zippers, buttons, etc.

Small items such as collars, cuffs, straps, socks, ties, and gloves can be placed directly on the **S-I-A™ adhesive tear-away stabilizer** and kept in place during the embroidery.

S-dSV™ adhesive backed water soluble film

S-dSV™ is for use with the Hoop-It-All™ in place of the **S-I-A™ adhesive tear-away stabilizer** when embroidering on sheers and see-through fabrics and wherever the back of the fabric could be seen, such as scarves, collars, lapels, purse flaps, etc. This stabilizer completely disappears in tap water leaving no unsightly stabilizer or adhesive residue.

For future purchases of Hoop-It-All™ stabilizers, we will gladly refer you to a dealer in your area. If there are no stocking dealers in your area call our customer service department at (800) 947-4911 or visit our web site at www.hoopitall.com.

Placing & removing Super-GIANT-L Hoop-It-All on Ellageo embroidery arm.

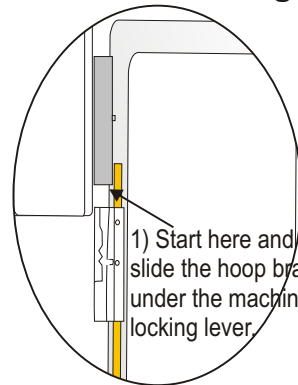

1) Start here and slide the hoop bracket under the machine's locking lever.

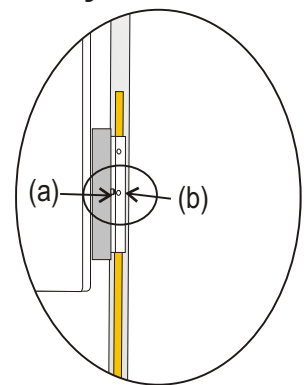

2) Slide hoop forward until the notch (b) on the hoop's bracket connects with the projected knob (a) on machine's locking lever to lock it in place.

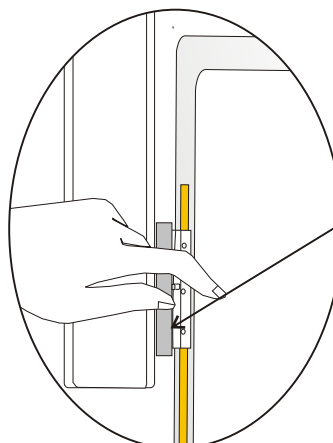

3) To remove the hoop off the machine's locking lever, press it in slightly to the left and then slide the hoop bracket toward you.

NOT INTENDED FOR EMBROIDERING ON CAPS!

For embroidering on caps, order our Cap Hoop-It-All™

Special Note - "Read first" before installing hoop on machine

The Super-GIANT-L Hoop-It-All™ should be used **only** after you are familiar with the embroidery editing features of your machine.

The hoops that come with your machine are designed to prevent the possibility of striking the hoop frame. The Super-GIANT-L Hoop-It-All™ is different from any hoops provided with your machine. It gives you the ability to over-ride the limited embroidery field of your machine by sliding and locking the hoop anywhere on the frame's sliding rail. It does not make the machine's embroidery field larger. However, by using software to split designs and/or combining different designs from miscellaneous embroidery cards this freedom allows you to decide just how and where you wish to place them on the fabric in just one hooping.

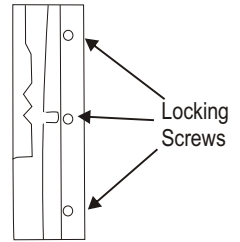

Stabilizing the Fabric

Before placing the fabric on the **S-I-A™ adhesive tear-away stabilizer**, using a hot iron press one layer of Hoop-It-All's **FaBond™ temporary tear-away stabilizer** to the back of the fabric. **FaBond™** helps to further stabilize the fabric but is easily removed after the embroidery is finished. It also helps in removing the **S-I-A** from the back of the fabric leaving no unsightly stabilizer residue. The coating on **FaBond™** also helps in keeping the needle clean and free from any adhesive build-up on the needle.

In addition to the above we also recommend one layer of our **dSV™ water soluble film** be placed on top of the fabric. This film aids with further stabilizing the fabric, keeps high nap fabrics from interfering, and gives a nice dimension to the embroidery thread.

You also can use our **S-dSV™ "adhesive" water soluble film** in place of the **S-I-A™ adhesive tear-away stabilizer** when embroidering on sheer fabrics, making lace, and whenever the back of the fabric may be seen. It completely washes out in tap water within minutes.

Use **dry Cover-Up™ permanent vinyl stabilizer** as a topping to enhance embroidery by matching thread color. Keeps base fabric from showing through the embroidery, and prevents embroidery from sinking into high loft fabrics. Gives a 3D effect. It is also available in Clear.

Step 1 **Easy placement**

After stabilizing the fabric as described above and before placing the **S-I-A™ adhesive tear-away stabilizer** on the back of the hoop frame, trace the inner edge of the frame, using a disappearing water soluble pen or Chaco-Liner by Clover onto the fabric where you want to place the embroidery. These lines will help when placing the fabric on the prepared hoop.

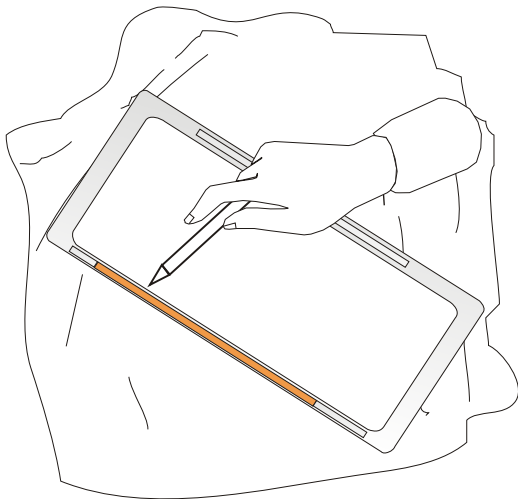

Step 2 **Attaching S-I-A™ adhesive tear-away stabilizer to the Hoop-It-All™**

Open the roll of **S-I-A™ adhesive tear-away stabilizer** provided with your hoop and cut off a 23" long piece.

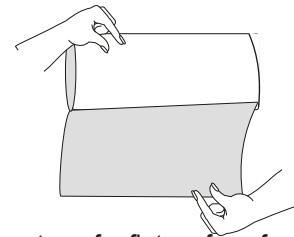

Place the Hoop-It-All™ on top of a flat surface face down and slowly peel the release liner off and hand press the **S-I-A™** adhesive side to the top backside of the hoop frame. Start pulling the release liner off and at the same time press the stabilizer to the sides and bottom.

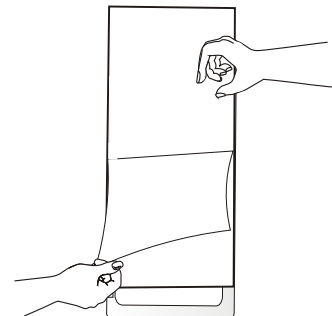

Step 3

Making certain the S-I-A™ adhesive tear-away stabilizer is taut -

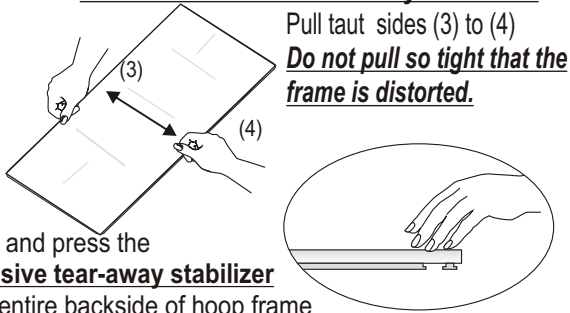

Step 4

Now firmly rub and press the **S-I-A™ adhesive tear-away stabilizer** all around the entire backside of hoop frame making certain it adheres well.

Step 5

Carefully cut away any extra **S-I-A™ adhesive tear-away stabilizer** extending out from under the hoop frame with a rotary Olfa cutter.

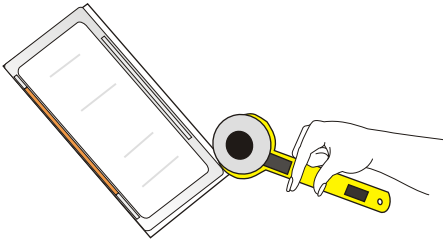

Step 6

With the Super-GIANT Hoop-It-All™ face up place the prepared fabric over the adhesive stabilizer matching the traced lines (as explained in Step 1) with the inner edge of the frame and gently rub/smooth fabric from center-out using a gentle pressure. Be sure to smooth entire surface of fabric making sure that the fabric bonds to the **S-I-A™ thoroughly in all areas without stretching or distorting the fabric.**

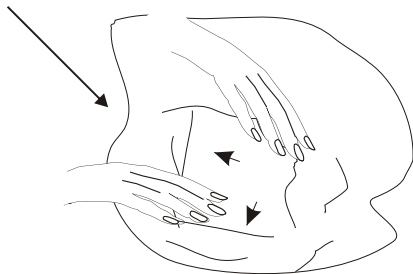

Step 7 Placing the Extension Table on the Machine

The extension table has been designed to give the GIANT Hoop-It-All™ the best support.

Before installing the GIANT extension table around the machine, make sure the machine is on a flat surface, and that you have sufficient clearance behind the machine for the GIANT 19" Hoop-It-All™ to clear any obstacles when the hoop is in its most rearward position.

If your machine is mounted on a sewing cabinet that allows your machine to go up and down on a platform, make sure the platform is up all the way. If the platform is still recessed from the surrounding table area, place a typing pad, or board under the machine so the base of the machine is level with the sewing table.

How the Super-GIANT-L Hoop-It-All works with this machine

The Sliding Super-GIANT-L Hoop-It-All™ is capable of embroidering two 6 1/4" x 10 1/4" designs in one hooping. However, when embroidering two border designs sized to their maximum always do a TRIAL trace to prevent the possibility of striking the hoop frame. It may be necessary to slightly decrease its size by 1/8".

To embroider the top half of the hoop *slide* the hoop so that the top end of the bracket is flush with the top end of the rail (Position A). Use the 3 locking screws (fig c) on the bracket to hold in place. With the TRIAL key on your machine check the pattern position before sewing.

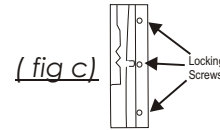

To embroider the bottom half of the hoop, slide the hoop so that the bottom end of the bracket is flush with bottom end of the rail (Position B).

Use the 3 locking screws on the bracket to hold in place. With the TRIAL key check the pattern position. Use the edit features of your machine and the *sliding* ability of the hoop to link the two designs.

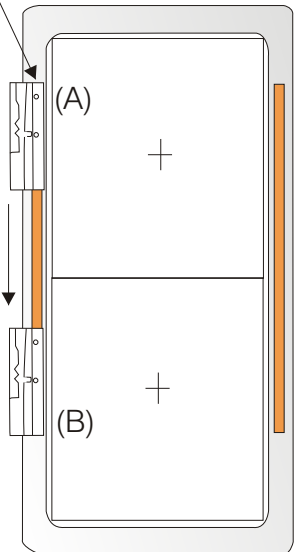

Monogramming across the length of the Super-GIANT-L Hoop-It-All™

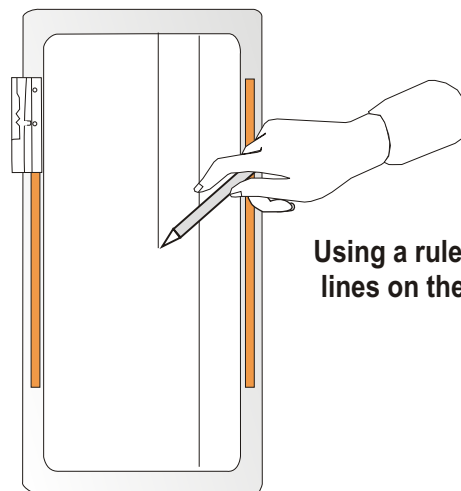

Using a ruler draw guide lines on the fabric.

Choosing a font and size of choice enter the letters
"I LOVE TO EMBROIDER":

*(The style and size of the font will determine how much
you can embroider in the "A" position) -*

Rotate 90 degrees to the right.

Using the **STARTING POINT KEY**
on your machine, choose the key
that starts the needle at the bottom
left corner.

**(Make certain the locking screws
have been tightened**

Use the EDIT arrow keys and
slide the hoop to make certain the
needle is on and at the beginning
of the first line.

Use the **TRIAL** key on machine to check the positioning of the
letters. Then Sew off "I LOVE TO EMBROIDER"

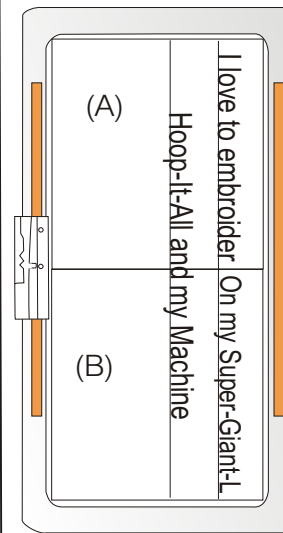
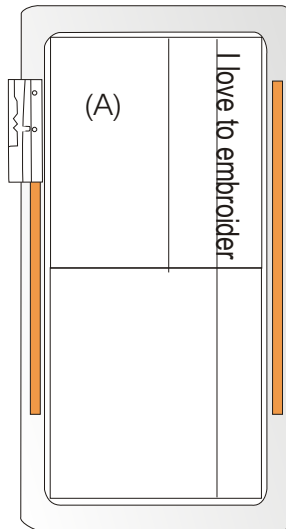

You need not be in position the **A**
or **B** position when the Design
is not at its maximum size.

Now enter -
"HOOP-IT-ALL and"

Edit and arrow to the 2nd drawn
line. Do a TRIAL trace
and slide the hoop in order to
center the letters. Lock in the hoop
and then sew off.

Now enter -
Space key and then
"my Machine"

Once again use the EDIT and sliding hoop to bring the
needle to the last stitch sewn.

**By entering the space key first when entering a new group
of words it will be easier to place the needle on the last
stitch, providing the correct distance between the words.**

***Adding smaller designs to your monogram
sample -***

Use the machine's LCD screen as much as you can for
placement of each design. Remember that you are not limited
by the screen's location since you can always slide the hoop
to where you want to sew each design.

Always do a TRIAL before starting and whenever possible
use templates to see the desired position of the design,
then slide the hoop and EDIT so that the needle is in the
correct position before you start sewing.

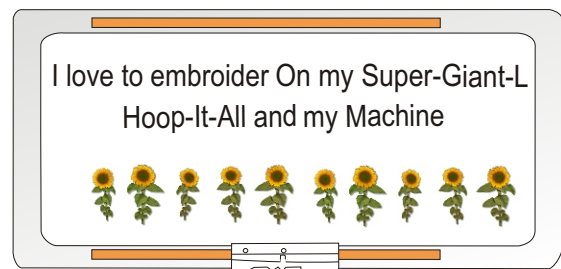

**ALWAYS CHECK TO SEE THAT THE LOCKING SCREWS
ARE TIGHTENED DOWN BEFORE YOU START TO
EMBROIDER.**

HINT:
Use our S-dSV™ adhesive-backed water-soluble
film on back of Hoop-It-All™ in place of the S-I-A
when embroidering on sheer see through fabrics
and embroidering lace motifs.

Now enter the letters -"ON MY SUPER-GIANT-L"

Following the previous instructions,
now slide the hoop into the
"B" position. EDIT and slide
the hoop to make certain the needle
is in the correct location before
sewing off. (See Hint below)

**(Make certain the locking
screws have been tightened
down!**

Hint: Enter the Space key prior to
entering this 2nd group of letters.
This will help in spacing the letters
evenly. The needle should be placed
in the last stitch made on the
previous set of letters.

