

**"MEDIUM"
HOOP**

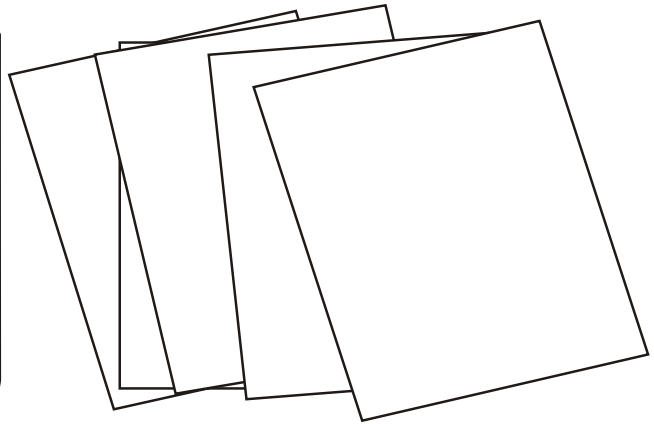
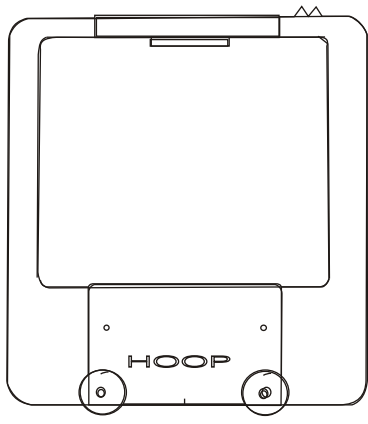
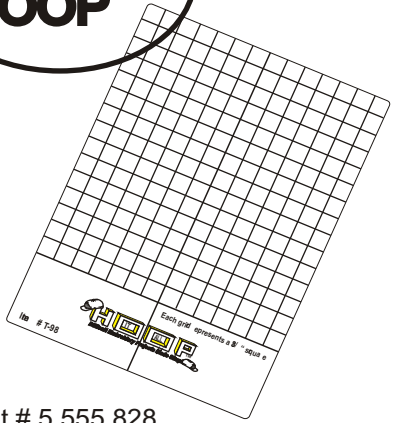

Patent # 5,555,828
Other patents pending

BERNINA artista 170/180

- Hoop-It-All kit includes:
- Hoop-It-All™ (embroidery hoop)
 - Placement Template
 - 5 sheets S-I-A™ stabilizer
 - Check Pointer (needle substitute)
 - Special instructions

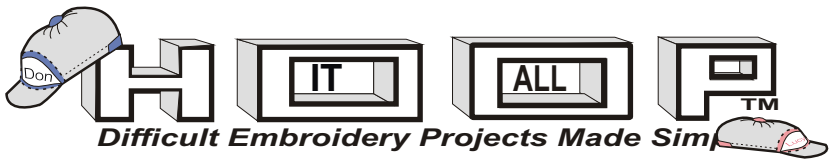

Hoop-It-All, Inc.
Prescott Valley, Arizona

For Baseball/Golf caps and other difficult to Hoop Items!

S-I-A™ adhesive stabilizer -

The Hoop-It-All™ includes 5 sheets of S-I-A™ adhesive stabilizer. This stabilizer is necessary for the hoop to function properly. It holds the fabric in place during embroidery, instead of two rings used with ordinary embroidery hoops.

No stretching is necessary which can distort and possibly damage the fibers in some fabrics increasing puckering. No ring marks are left on velvet, suede, or corduroy. Embroidery can be done anywhere on the garment without interference caused by seams, pockets, facings, zippers, buttons, etc.

Small items such as: collars, cuffs, straps, socks, ties, and gloves can be placed directly on the S-I-A™, and kept in place during the embroidery.

The Hoop-It-All™ is flat preventing unnecessary lifting of fabric around the edges on bulky items such as purses, caps, dashboard covers, shoes, etc.

S-dSV™ adhesive water soluble stabilizer -

S-dSV™ is for use with the Hoop-It-All™ in place of the S-I-A™ when embroidering on sheers and see-through fabrics and wherever the back of the fabric can be seen, such as scarves, collars, lapels, purse flaps, etc. This stabilizer completely disappears in warm water leaving no unsightly stabilizer or adhesive residue.

When possible Hoop-It-All, Inc. will refer you to a dealer in your area for future purchases of Hoop-It-All™ stabilizers. If no dealer is available call our customer service department to order direct.

Placing and removing the Hoop-It-All™ on the artista embroidery module.

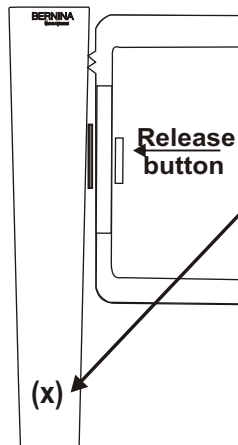

To attach the Hoop-It-All™ bring the hoop bracket to the artista embroidery module bracket. **While depressing the CENTER of the release button push down firmly on the hoop bracket.**

IF THE RELEASE BUTTON DOES NOT POP OUT, IT IS NOT LOCKED IN PLACE. With one hand support the bottom of the embroidery module (x) as you continue to push down on the gold bracket.

To remove the hoop while fully depressing the CENTER of the release button lift the hoop off the artista embroidery module bracket.

The Release Button must be depressed either in the center or with two fingers on each side. It does not release when only one side is depressed.

If adhesive residue should remain on the back of the hoop, use rubbing alcohol, "Goo-Gone", or "De-Sov-it" to clean it.

Instructions For Caps -

Preparation of Foam and Fused Backed Buckram Caps -

Step 1

- Place Cap over your knee and with a water soluble marking pen and ruler mark the horizontal placement line 1 3/4 inch from bill edge directly on front of cap.



- Place ruler vertically aligning edge with top seam front and mark the center placement line.



Step 2

- Loosen the back strap to allow for flexibility.
- Turn hat over so that the visor is facing upside down.
- Staple or tape the sweat band to cap bill to prevent the embroidery from being stitched to it. Scraps of S-I-A™ can be used as tape.



Preparation of Hoop-It-All™ -

- Separate S-I-A™ from the release liner by sliding your thumb nail against the S-I-A™ away from one corner. Peel back about two inches across one end.
- Place the sticky side along the back top edge of the hoop and press firmly down.
- **Do not cover the notches that determine the hoop size on the edge of the hoop.**

Do not cover the notches on the hoop with the S-I-A™.

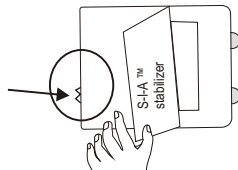

- Grasp the shiny backing paper and pull toward the other end of hoop.
- Place and press the S-I-A™ evenly along the sides and bottom of hoop so it remains **taut** during the embroidery. Be sure to **Firmly** press S-I-A™ on hoop to prevent it from pulling loose and causing puckering of the fabric during embroidery..

Hats with Stand-up Loose Buckram (non-fused) -

- Cut the loose buckram liner about 1.5 inches on each side, where it is stitched to the visor. This allows the buckram liner to bend to the front visor easily.
- Pull firmly to front edge of visor and staple or tape together.

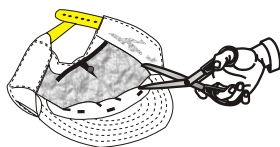

CAUTION: WHEN CAP IS ON HOOP REMOVE THE PRESSER FOOT AND NEEDLE BEFORE USING THE CHECK FUNCTION. PLACE THE FLEXIBLE "CHECK POINTER" (PROVIDED) INTO NEEDLE CLAMP DURING THIS OPERATION.

The Bernina artista 170 and 180 are programmed to check the hoop size each time it traces a design by moving down to the lower right corner of the hoop. If the needle and presser foot are on the machine, they could get caught in the bulky areas.

Placement of Ball Cap on Hoop-It-All™ Frame -

- Loosen visor clamp nuts (spin knobs).
- Slide visor under clamp.
- Attach template holes over studs on clamp plate. (see below).
- Move cap forward until it is aligned according to the above instructions.

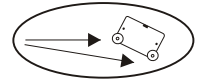

Place template holes over protruding studs on clamp plate.

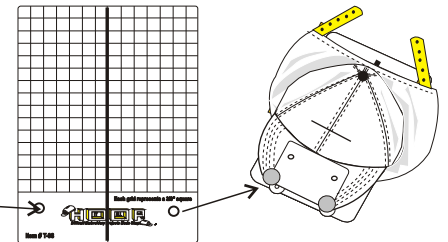

Cap template placement- Use bold vertical center line and the 7th horizontal line from top edge of template to guide you with centering.

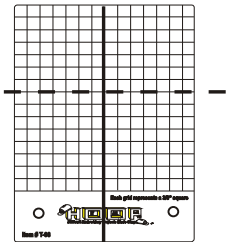

Pattern must be pivoted 270 degrees when embroidering on caps!

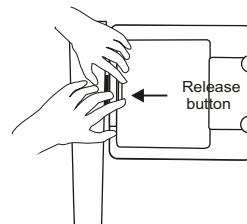

MUST PUSH IN CENTER OR BOTH SIDES OF RELEASE BUTTON AT SAME TIME TO PLACE ON AND TAKE OFF EMBROIDERY MODULAR.

If not perfectly centered use arrow keys to bring needle to center cross lines MARKED ON FABRIC..

HINT: Use a permanent marker pen to custom revise the template.

- Press cap down against the S-I-A™ adhesive backing starting in the middle and working out toward the edges.
- Carefully lift edge of visor on the right side and tuck the panel fabric under the visor against the adhesive. Repeat on the left side.

HINT: Use the new center line marked on the S-I-A™ to help in placement of cap.

Spread open the cap and bring inside back seam to the vertical line marked on the top of the Hoop-It-All™.

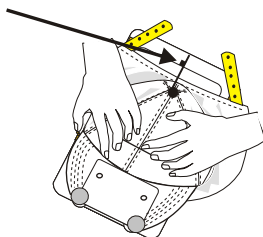

Placing hoop with Cap on artista embroidery modular.

Starting from the back behind the needle bar, slide the hoop forward under the foot at left front corner of hoop and cap bill.

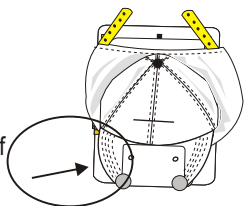

The Release Button must be pushed in either the center or with two fingers on either side. It will not release if only one side of the button is pushed in. This is required when placing the hoop on or off the machine.

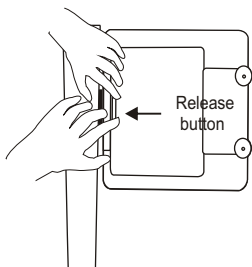

Remove the needle and presser foot from machine. Insert the flexible CHECK POINTER (included) to the needle clamp area. You are now able to trace the pattern with the cap on the machine. Bring the CHECK POINTER down to the center mark to check centering. **REMEMBER TO REPLACE THE CHECK POINTER WITH A NEEDLE AND PLACE THE PRESSER FOOT BACK ON THE MACHINE BEFORE EMBROIDERING.**

Removing the hoop and cap from embroidery module -

You must push the Release button on the Hoop-It-All™ in order to remove it from the artista embroidery arm. Use the same steps as when placing it on the machine.

After the embroidery is finished, loosen the Hoop-It-All™ clamp and carefully place both hands between the cap and the S-I-A™ stabilizer pulling upward toward the center of the embroidery. This prevents excessive tearing of the S-I-A™ adhesive stabilizer.

You need only patch the area torn portion on the S-I-A™ for next project.

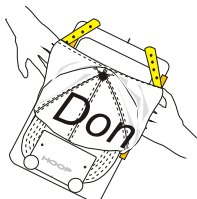

S-I-A™ and Hoop-It-All™ are trade marks of Hoop-It-All, Inc. Bernina Artista hat 170/180

HOW TO PREPARE FOR THE NEXT PROJECT:

- 1 - Although you need not replace the entire piece of S-I-A™ it is advised that it be cut large enough to be attached to the back of the hoop on both sides and at least two inches above and under the open area. Make certain it is nice and **VERY TAUT**. In large designs it may be best to replace the entire piece of Stick-It-All™.

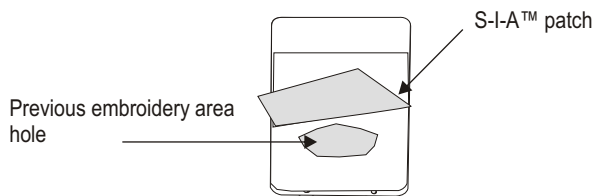

- 2 - Turn the hoop over and lightly attach the patch to the area to be covered.

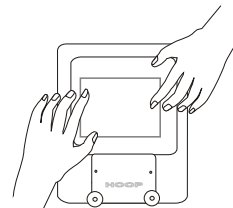

- 3 - Place hoop facing up on a flat surface and lay the shiny side of the release liner over the patched area. Firmly press down around the patch to make certain it is attached well on all sides.

Embroidering on Small Items

Mark center lines directly on S-I-A™ adhesive stabilizer.

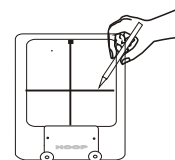

Place small item directly on the S-I-A™ adhesive stabilizer so that it is centered with the lines marked on it. Spread open surrounding area pressing it to the S-I-A™.

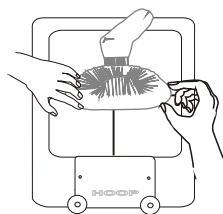

You may prefer to use the clamp to restrain the toe of the sock during embroidery.

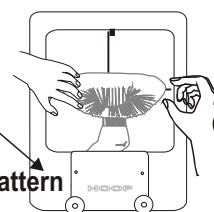

Remember to rotate pattern 180 degrees.

The S-I-A™ holds the item in place while you embroider.

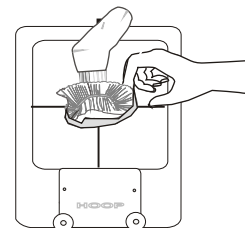

Gently remove the item from the S-I-A™ adhesive stabilizer.

EMBROIDERING WITH BULKY FABRICS. It is difficult to properly align a large garment before embroidering by regular hooping methods. The following suggestions are possible solutions:

1 - Mark placement area with water soluble or air dry pen. (First test the ink on an area not visible to make sure it disappears). **Intended for unlined garments only.**



2 - Before applying S-I-A™ to back of frame, place the Hoop-It-All™ frame **on top** of marked area on garment. Then trace around the inside of the hoop with a water soluble pen.

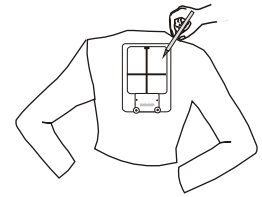

3 - Remove hoop frame from the garment.

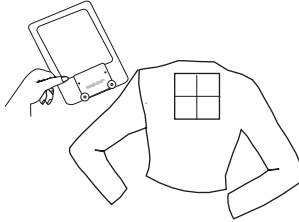

4 - Lay hoop face down on a flat surface and attach S-I-A™ firmly to the backside. Hand press all around the back of hoop to make certain the adhesive stabilizer is taut and adhering well to the entire bottom.

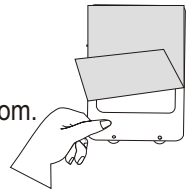

5 - Turn hoop face up on flat surface.

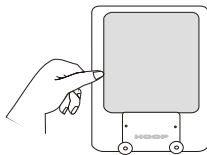

6 - Mark the placement lines on the adhesive side of the S-I-A™.

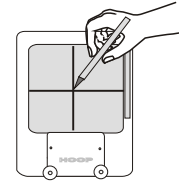

Use the marked lines on S-I-A™ to guide you with placement of fabric on hoop.

7 - Spread the garment open and place the marked area over the hoop. With your finger tips feel the traced area on the fabric all around the inner opening of the frame.

8 - If you have a light box and it is possible to see through the fabric, place the box under the Hoop-It-All™. The placement lines are now visible. Lightly place the fabric area to be embroidered on the hoop matching the lines marked on the fabric with those marked on the S-I-A™. When sure of the placement smooth the fabric with your hands to the adhesive until it adheres well.

9 - If you do not have a light box, insert a pin into the center hole of template that came with your machine, through center marked on your fabric and continue to stick the pin into the center marked on the S-I-A™ **on a padded surface.** Gently spread the fabric to the right and place the pin into the right hole on template, through horizontal outer right lines marked on the fabric and S-I-A™. Repeat these steps on left, upper and lower lines. Then hand press the fabric carefully to the S-I-A™ so it lies flat and adheres well to the stabilizer. Other non-adhesive stabilizers can be placed under the hoop and S-I-A™ when additional stability is needed to prevent any possible puckering.

10 - Be careful that no loose fabric gets in the way underneath the hoop while embroidering.

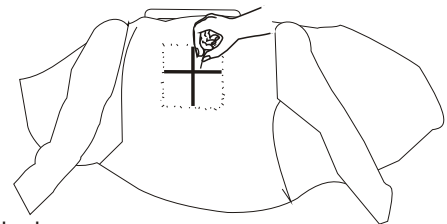

11- Other adhesive stabilizers can be used in place of the S-I-A™ such as the 7 primary colors and Clear Cover-Up™. S-dSV™ adhesive backed water soluble film can also be substituted for use with sheer fabrics.

